

Investment Proposal

1. General Information			
Name		for the construction and maintenance of a specialized retail building (land plot for retail facilities)	
Total area (m ²)		593	
Location	Region	Gomel	
	District	Novobelitskiy	
	Settlement	Gomel	
	Address	2 nd Lunacharskogo Street, 26A	
Form of property		<input type="checkbox"/> private	<input checked="" type="checkbox"/> public
Name of owner		Gomel City Executive Committee	
Possible fields of use		<input type="checkbox"/> industry	<input type="checkbox"/> trade <input checked="" type="checkbox"/> mixed
		<input type="checkbox"/> logistics	<input type="checkbox"/> service <input type="checkbox"/> other (specify)
Means of land plot provision		<input checked="" type="checkbox"/> lease	<input type="checkbox"/> use <input type="checkbox"/> sale
Value (cadastral)		90,011.47 BYN, 151.79 BYN per m ² , 59.94 USD per m ²	
Encumbrance of the plot/ building		sanitary protection zone of drinking water supply sources of centralized drinking water supply systems, encumbrances due to the presence of fruit trees on the land plot, wild shrubs and other objects of plant life, construction and household waste	
2. Transport Communication			
	Distance from the facility	Name	
Highway	5 km	—	
Republican class highway	0.5 km	—	
Airport	11 km	—	
Railway	0.5 km	—	
Availability of access routes		Available	
Other		—	
3. Infrastructure			
	Distance from the facility	Description (power, volume, etc.)	
Electric power supply	Available	—	
Heating (heating networks)	—	—	
Potable water	Available	—	
Process water	—	—	
Hot water service	—	—	
Boreholes	—	—	
Sewerage	Available	—	
Gas supply	Available	—	
Other (including adjacent structures: industrial enterprises, raw material base)		—	
4. Contact Information			
Contact Person (Position)		Chikina Natalya Petrovna (Deputy Head of the Land Management Department of the Gomel City Executive Committee)	
Phone number		+375 232 31 09 46	
Fax		+375 232 32 90 26	
E-mail		zem@gorod.gomel.by	

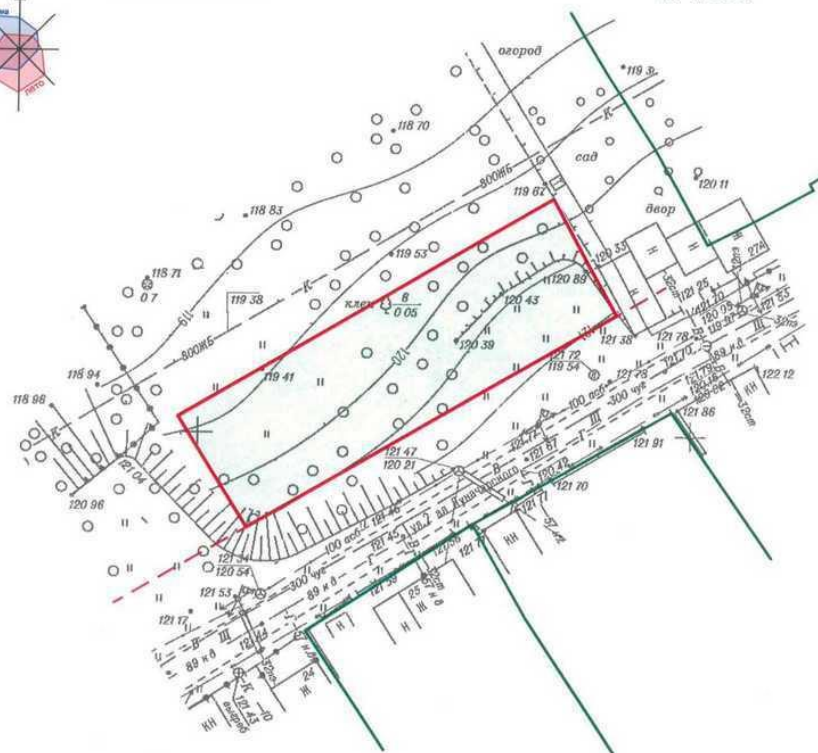

**Планировочная схема земельного участка для
строительства здания специализированного розничной
торговли по ул. Луначарского 2-я (район жилого дома №27А)
в городе Гомеле"**
М 1:500

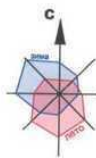

Ситуационная схема



Условные обозначения

- участок для размещения
объекта (ориентиров. - 0,0586 га)
- граница земельных участков смежных
землепользователей (фрагмент)
- красная линия

местоположение участка